

Focus Mounting & Framing



Mounting & Framing Solutions



Pixfix



Every application must be tested if suitable for materials and weight, when using adhesives follow manual instructions carefully.

Pixfix will inspire you to be more creative when hanging a sign. Without the need to drill holes in your signage it will secure the sign to the wall invisibly. Thanks to the clever insert system you can simply exchange the panels at anytime. Pixfix is suitable for all materials and can be mounted with screws, adhesive or silicones. The Pixfix can be your perfect solution for mounting photos, wall direction sign systems, POS graphics or any sign that you really want to look high quality with no holes or fixings showing.

How to Use

- Remove adhesive tape foil
- Mount Pixfix to the panel
- Mount the wall support to the wall
- Simply click in your panel

Description

Pixfix



Max Weight



Wall Distance



Hole Dia



Remove adhesive tape foil



Mount Pixfix to the Panel

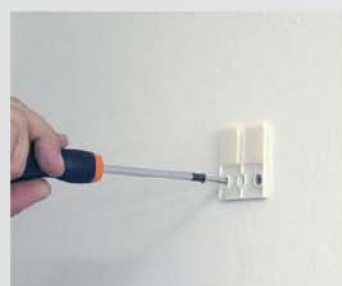

Mount the wall support to the wall

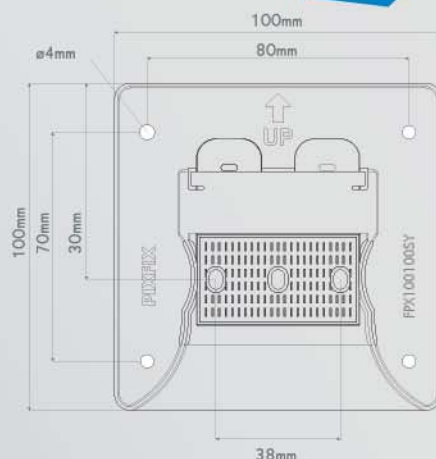

Mounting & Framing Solutions



Backframe **NEW**

Backframe is a mounting system especially for thin and flexible panels made of hard-foam, forex or aluminium. It helps to stiffen the panel, while mounting is easy and safe.

The leveling system is particularly convenient for the mounted panel, that can even be up to 10mm, so that your panel will always be straight without drilling new holes.

We provide you with complete sets for common formats. Also available are all lengths extra to create new sizes.

- ✓ Mounting and strengthening of thin, flexible panels.
- ✓ Convenient positioning straps.
- ✓ Adjustable horizontal leveling.

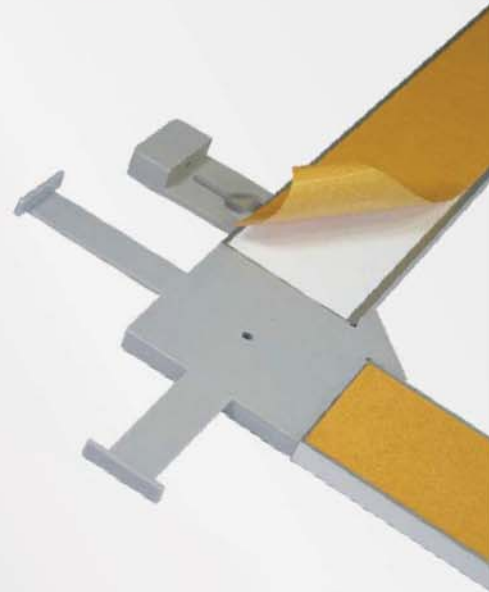

Code	Size
FBAFA3	A3
FVAF700500	700 x 500mm
FBAFA1	A1
FBAF1000700	1000 x 700mm
FBAF14001000	1400 x 1000mm



Mounting & Framing Solutions

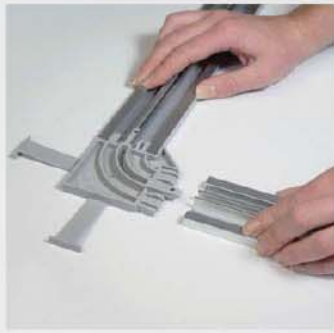

✓ Assemble frame

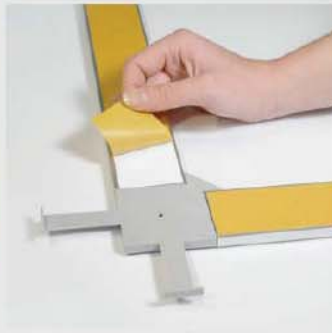

✓ Apply double-sided adhesive tape

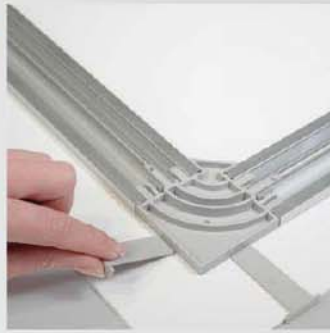

✓ Position frame with positioning straps



✓ Tear away straps to wall mount panel

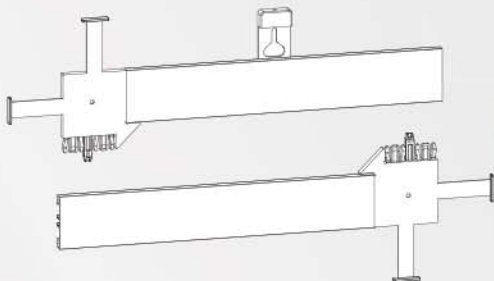
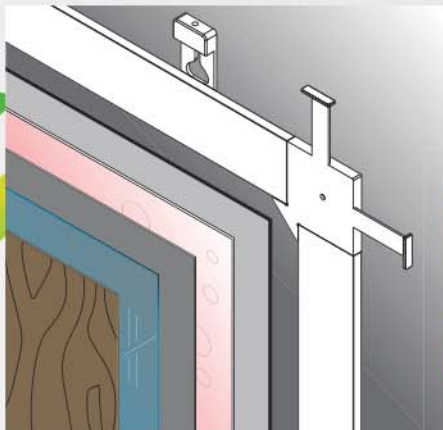

Plastic Edge Corner

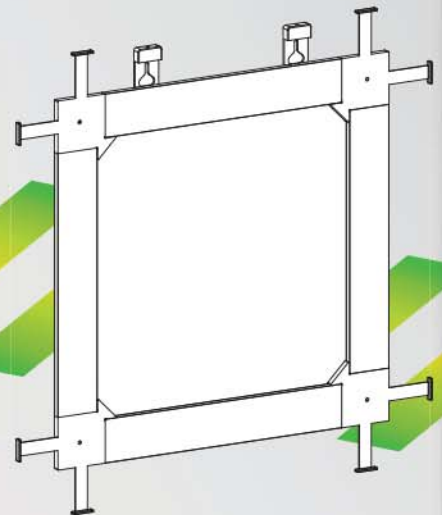

Wall hook with levelling: evens up to 10mm after wall mount



Mounting & Framing Solutions

e-Xhibit[®] frame-system **NEW**

The Perfect Frame for Fine Art Prints

Fine art prints, photographs or information panels: The E-Xhibit frame system is the presentation solution for all things on aluminium composite panels-whether in museums or galleries, shop construction, architecture or design. Hidden raw edges and wall clearances of 25mm, 50mm depending on profile, make for a premium presentation of aluminium composite panels.

The system can also be used with plastic or magnetic panels and mirrors up to 3 mm thickness. The panels can be fitted using magnetic and steel tape or adhesive tape.

Size

A4

A3

A2

A1

A0

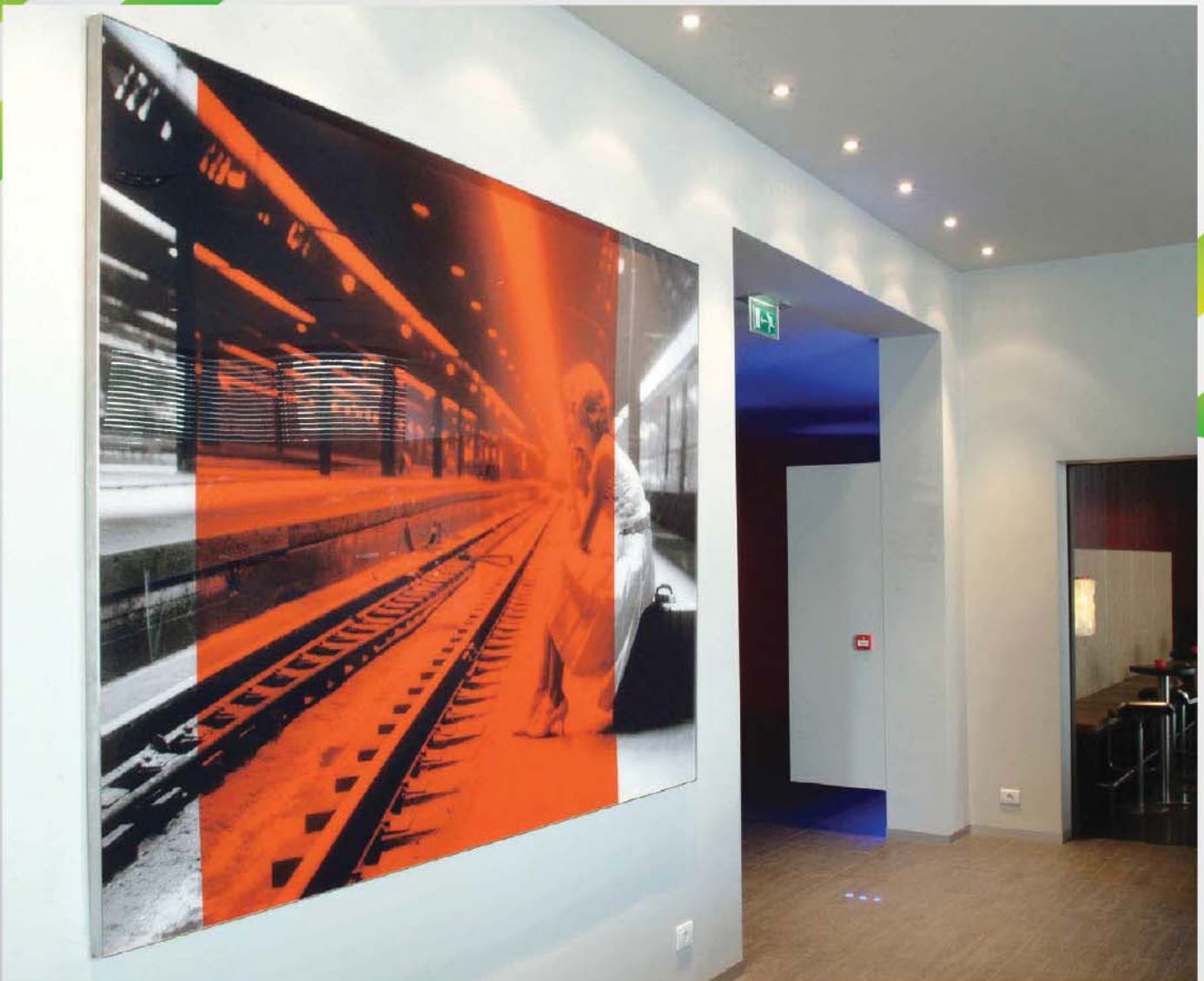

Mounting & Framing Solutions

E-X25

Framing System	E-X25
Frame Depth	25mm
Frame Width	2.5mm
Insertion Depth	5.5mm
Contact Surface	30mm
Size	Min: 300mm x 300mm Max: 4,000mm x 2,000mm
Colour	White / Black / Silver



E-X50



Framing System	E-X50
Frame Depth	50mm
Frame Width	2.5mm
Insertion Depth	5.5mm
Contact Surface	30mm
Size	Min: 300mm x 300mm Max: 4,000mm x 2,000mm
Colour	White / Black / Silver



E-X14

Framing System	E-X14 Light
Frame Depth	14mm
Frame Width	1.5mm
Insertion Depth	5.5mm
Contact Surface	21mm
Size	3,900mm Length
Colour	Silver



Fixings for Freestanding Signs



IX Bond connects 3mm – 10mm panels infinitely and free of torsion. The face joint remains at a discrete 6mm. The screw can be mounted from both sides which is convenient if you are creating structures in 3D or close to walls. Ergonomic and decorative recessed grips make mounting easy. Order the required keys separately.



16mm
Max Panel

Code	Type
IX2B60AR	60°
IX2B90AR	90°
IX2B120AR	135°
IX2B180AR	180°
IX2BSWAR	Sandwich Connector

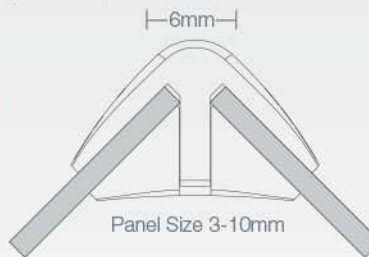

Fixings for Freestanding Signs

60° Connector

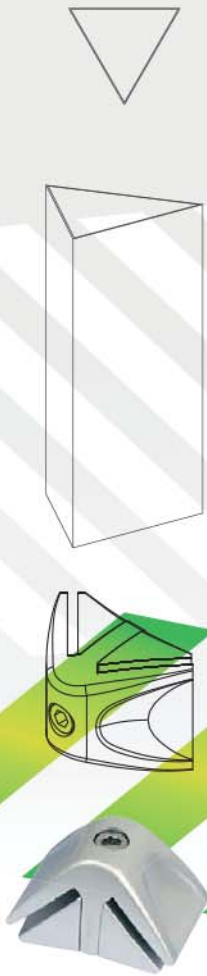

90° Connector



135° Connector

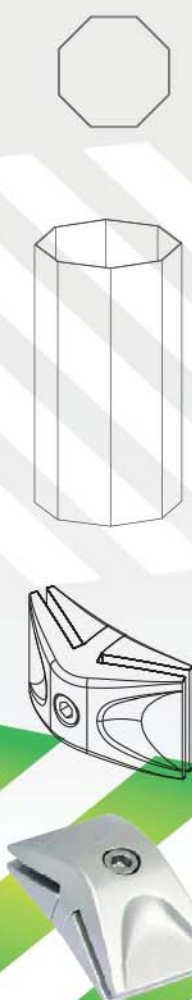

180° Connector

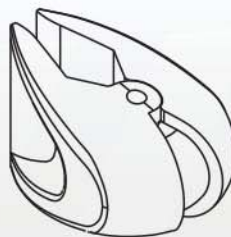
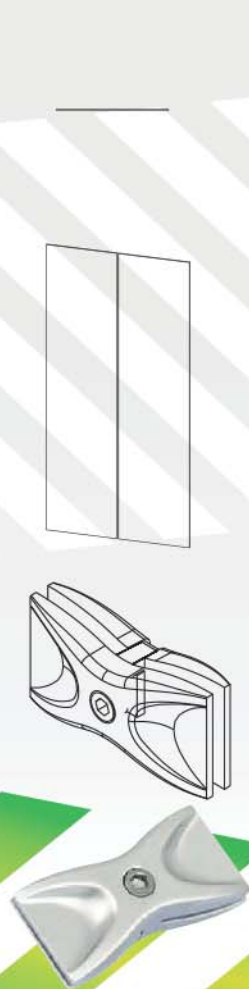

Lock



Sandwich Connector

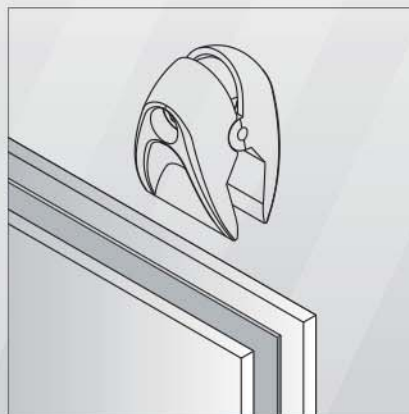

Fixings for Freestanding Signs



Connector

Shock resistant panel connector made from glass green polycarbonate for modular cube systems. Create your own personal display cabinet with 5mm panels and connectors. The drawings on this page will help you choose the correct connectors. It's a great solution for designers and sign makers helping make great merchandising displays in shops and showrooms, museums, shop windows and exhibitions.

Code	Type
FCONA	Connector A
FCONB	Connector B
FCONC	Connector C
FCOND	Connector D
FCONE	Connector E
FCONF	Connector F
FCONG	Connector G

