

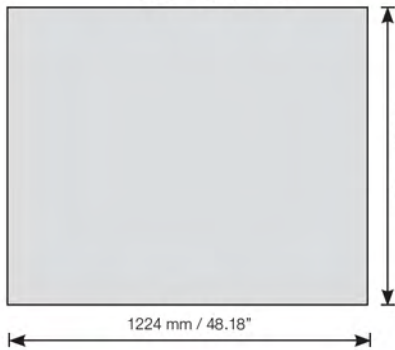

counter panel

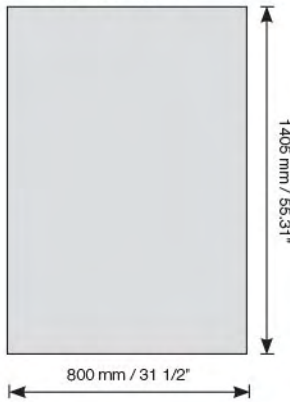

monitor panel



ISOframe Wave integrated Counter can support a monitor up to 25kgs



1 stand 1 person endless possibilities  
[www.focusonline.ie](http://www.focusonline.ie)

## Semi-circular table module

Item.no IS-9415-1/2

### Complete with:

- 1 post with feet,
- 1 counter top and 1 base plate,
- 2 table posts,
- 4 table feet,
- 2 T-box connectors,
- 1 graphic stiffener,
- 1 set kicker and hanger



## Accessories



**LED spotlights in bag**  
12V / 18 W Incl. transformer  
Item IS-SL-LED



**Bag for table**  
Item IS-80-TB05



**Floating shelf, item IS-9454**



**Large LCD holder**



**Slatwall system**



**1** Screw in the 4 adjustable feet in the base plate so the height from the floor will be 22 mm/0.86".



**2** Attach the base plate to an existing module and to the included base post.



**3** Complete the post with the extension and top post.



**4** Attach the 2 table posts and lock the bottom FASTclamps.



**5** Attach the 2 T-box connector on the inner edge of the post mag tape, with mag tape on the T-box facing outward (facing right on the right hand post, left on the left hand post).



**6** Attach the table top and lock the 2 FASTclamps on the reverse side...



**7** ...and the 2 FASTclamps at the posts. Attach the graphic panels and the table installation is complete.

1 stand 1 person endless possibilities

[www.focusonline.ie](http://www.focusonline.ie)

## Mounting instruction

### Large LCD holder

Item.no IS-80-TM03

VESA 400x200

Max weight. 20 kg / 44 lbs

**Complete with:**

2 horizontal beams with LCD holder, 2 rails for LCD, screws for mount of the LCD.

Can be used with the **Wave, Compact and Exhibit system.**



*Note: LCD brackets may vary based on availability. Be sure to follow additional inclosed instructions for attachment to your TV/LCD screen.*

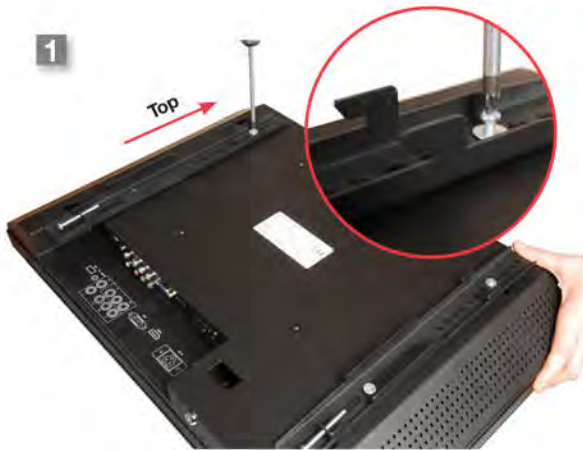

Attach the 2 rails on the LCD screen



Attach the LCD holder in the system with the 4 FASTclamp locks.

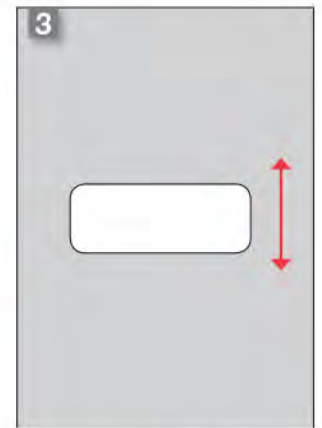

Cut an opening in the graphic panel in the size of 520 x 220 mm / 20 1/2 x 8.7" (or to fit bracket provided)



Attach the graphic panels



Hook on the LCD



Lock the LCD with the two screws in the bottom of the screen rails!